

### DETALLE DE RAMPA

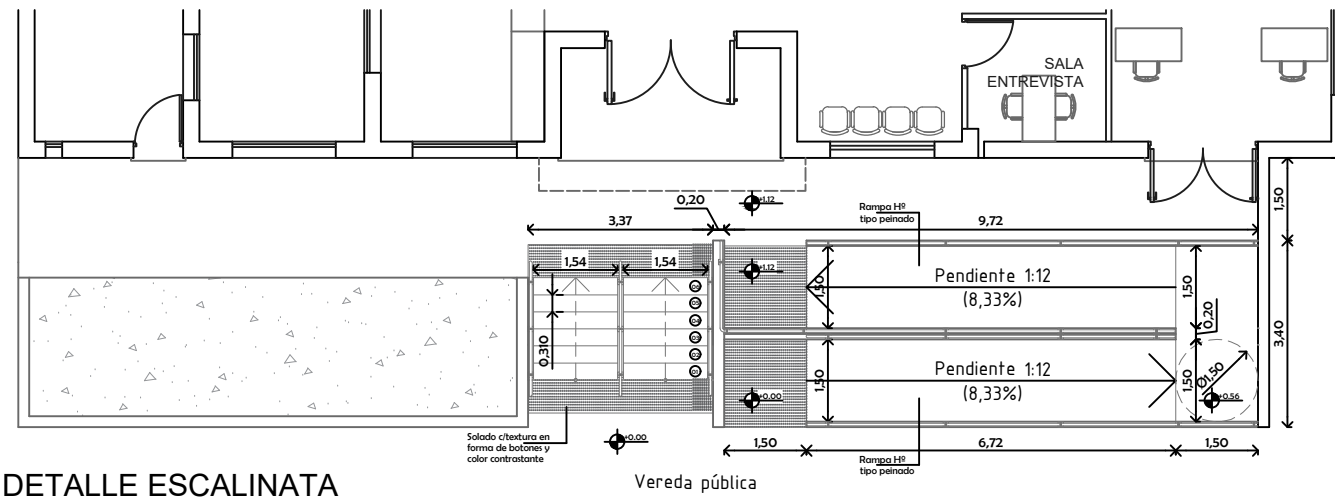

**DETALLE ESCALINATA**  
H17 - ADN420

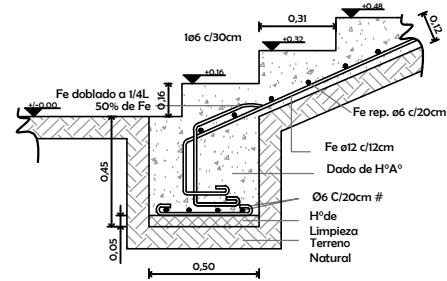

**Cálculo**  
2a + p = 61 a 63 cm.  
2\*15 cm + 31 cm = 61 cm

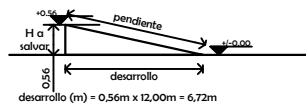
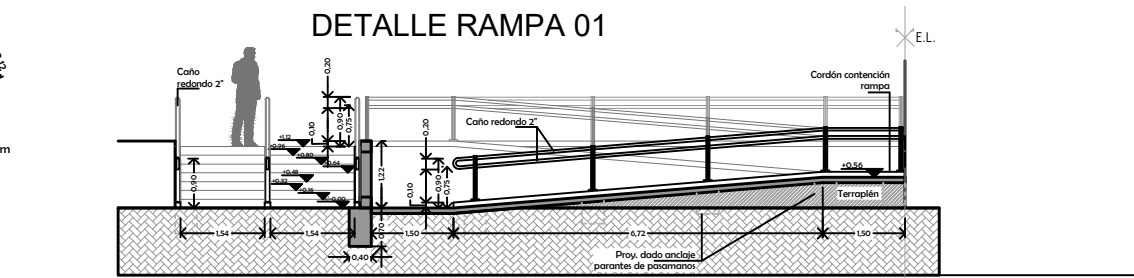

### DETALLE DE ESCALERA

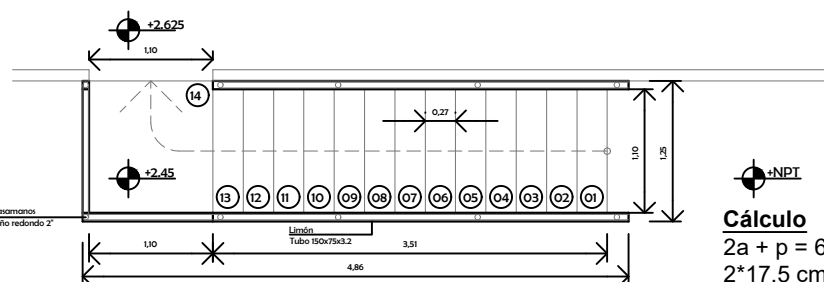
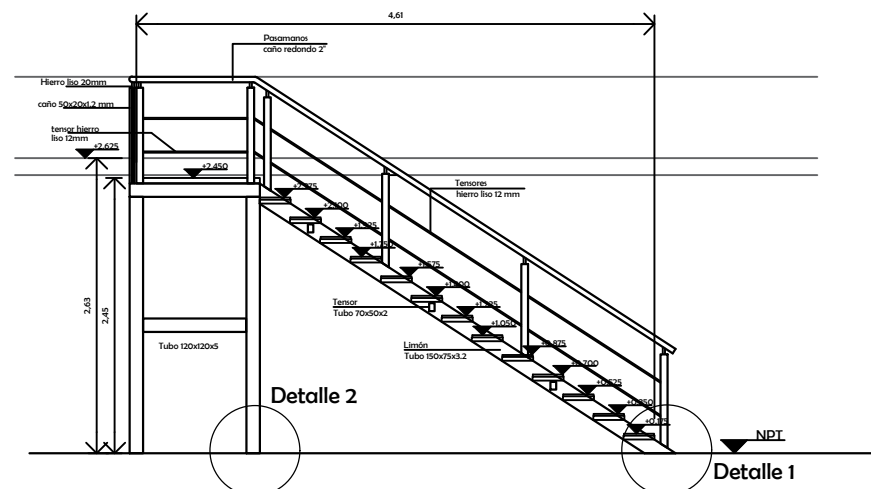

**Cálculo**  
2a + p = 61 a 63 cm.  
2\*17.5 cm + 27 cm = 62 cm

### Detalle escalera

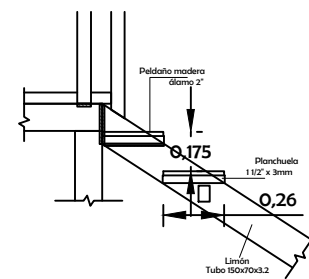

### Detalle 3

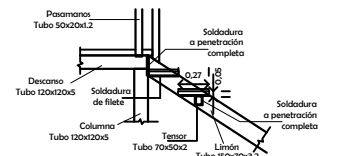

### Detalle 2

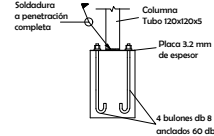

### Detalle 1

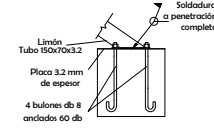

### DETALLE CERCO PERIMETRAL

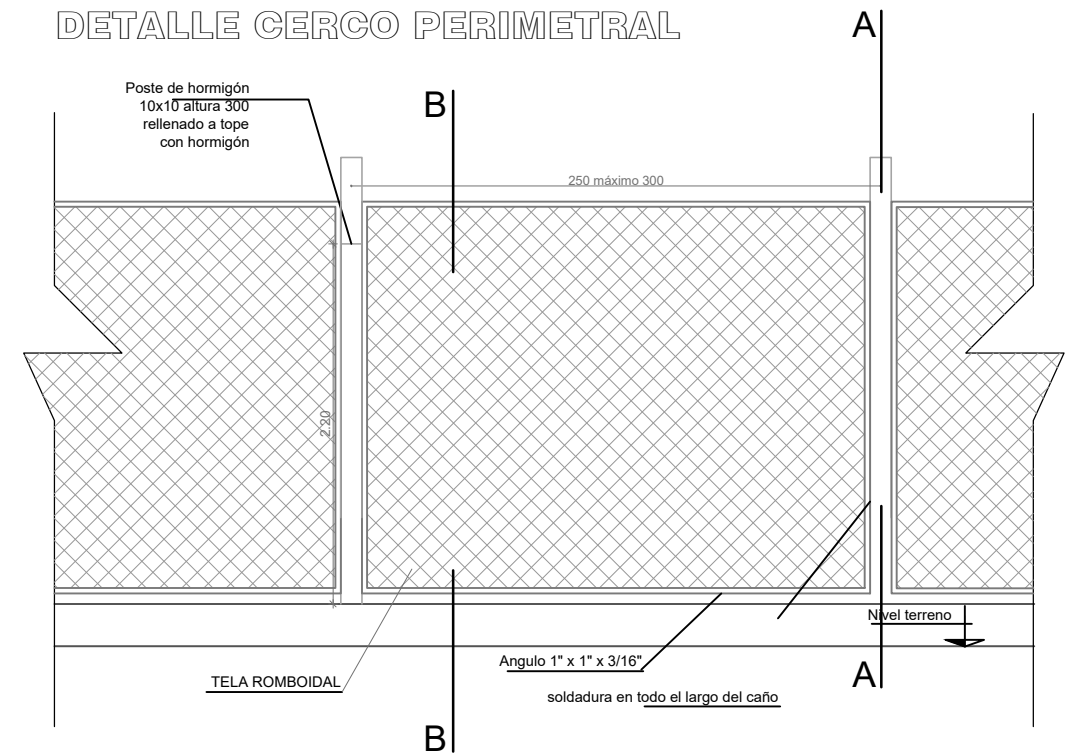

### CORTE A-A

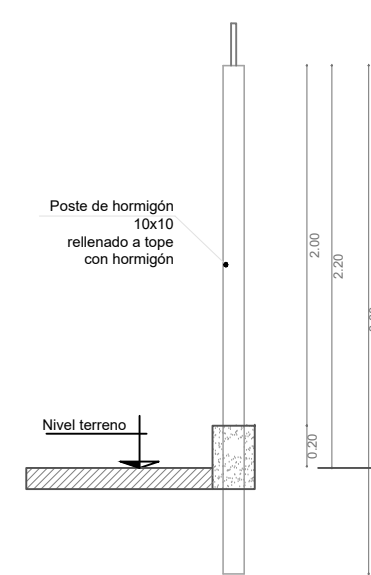

### CORTE B-B

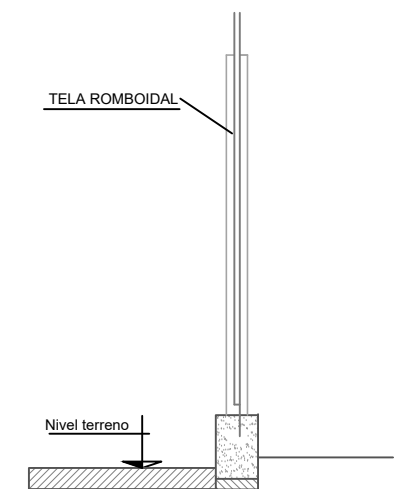

### NOTAS

- Los cierres perimetrales que se indican en el detalle se hará en todo en el contrafrente y laterales desde el contrafrente como se indica en plano El frente no tendrá cierre.
- La obra cumplirá en un todo con las exigencias del reglamento interno

<b>PODER JUDICIAL DE SAN JUAN</b> DEPARTAMENTO DE SERVICIOS GENERALES		<b>PLANO Nº 04</b>
PROYECTO: UNIDAD FISCAL DE INVESTIGACION (UFI) VARIOS - JÁCHAL		 ESC. 1:100
PLANO: DETALLES	Revisión Nº00	